

HAILEA[®]

SINCE 1989

ISO9001:2000 ISO14001:2004

Model F20

Tank Capacity:20L

Fluorescent Spec.:110-120V/220-240V/7W

Model F30

Tank Capacity:30L

Fluorescent Spec.:110-120V/220-240V/11W

Model F60

Tank Capacity:60L

Fluorescent Spec.:110-120V/220-240V/24W



F30

FASHIONABLE AQUARIUMS



F20
Dimensions:360x240x310mm



F30
Dimensions:360x240x380mm



F60
Dimensions:590x335x490mm

FEATURES

- Glass of high strength and clarity and with an excellent vision.
- Waterproof illuminating system with sufficient light. High efficiency and energy saving, safe and reliable.
- Quick to install, convenient to maintain.
- Elegant and fashionable. An ideal choice for home, office, leisure ornaments.

ORIGINAL DESIGN

TOP COVER WITH TWO SMALL COVERS, CONVENIENT TO FEED AND MAINTAIN.

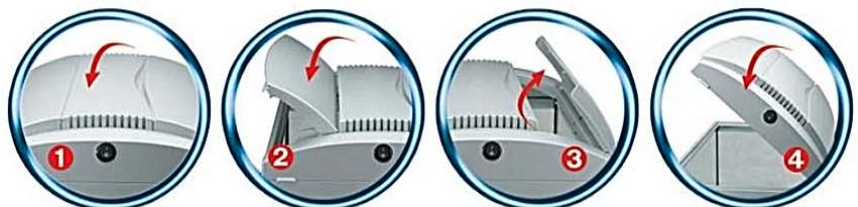

HAILEA AQUARIUM LINE PRODUCT

MINI AQUARIUM



COLOR SELECTION

-  BLACK
-  SILVER

Model Fa400 (PL light)
 DIMENSIONS: 480X360X428MM
 TANK CAPACITY: 60L
 LIGHTING: PL LAMP 26W
 FILTER: BUILT-IN SYSTEM
 WATER PUMP: 380L/H 6.5W
 WITH 1 FAN



COLOR SELECTION

-  BLACK
-  SILVER

Model FA400-A (T5 light)
 DIMENSIONS: 480X360X428MM
 TANK CAPACITY: 60L
 LIGHTING: T5 LAMP/8WX2
 FILTER: BUILT-IN SYSTEM
 WATER PUMP: 380L/H 7W



COLOR SELECTION

-  BLACK
-  SILVER

Model FA400-B (with internal filter)
 DIMENSIONS: 480X360X428MM
 TANK CAPACITY: 60L
 LIGHTING: T5 LAMP/8WX2
 FILTER: INTERNAL FILTER 7W



COLOR SELECTION

-  BLACK
-  IRON-GRAY
-  SILVER

Model FA300 (glass front, plastic back)
 DIMENSIONS: 385X245X318MM
 TANK CAPACITY: 28L
 LIGHTING: LAMP 15W
 FILTER: BUILT-IN SYSTEM
 WATER PUMP: 200L/H 4W



COLOR SELECTION

-  BLACK
-  IRON-GRAY
-  SILVER

Model FA300-A (glass front, glass back)
 DIMENSIONS: 380X254X335MM
 TANK CAPACITY: 28L
 LIGHTING: LAMP 15W
 FILTER: BUILT-IN SYSTEM
 WATER PUMP: 200L/H 3W



COLOR SELECTION

-  BLACK
-  IRON-GRAY
-  SILVER

Model FA300-B (with internal filter)
 DIMENSIONS: 380X254X335MM
 TANK CAPACITY: 28L
 LIGHTING: LAMP 15W
 FILTER: INTERNAL FILTER 3W



COLOR SELECTION

-  BLUE
-  PURPLE
-  SILVER

Model FC200-1
 DIMENSIONS: 215X140X280MM
 TANK CAPACITY: 6.6L
 LIGHTING: LAMP 5W
 AIR PUMP: 1.3L/M 1.8W



COLOR SELECTION

-  BLUE
-  PURPLE
-  SILVER

Model FC200-2
 DIMENSIONS: 215X140X280MM
 TANK CAPACITY: 6.6L
 LIGHTING: LAMP 5W
 WATER PUMP: 200L/H 3W



COLOR SELECTION

-  BLACK
-  PURPLE
-  RED
-  GRAY

Model V-01 2.8L
 DIMENSIONS: 180X180X140MM
 TANK CAPACITY: 2.8L
 LIGHTING: LED LAMP
 COLOR: BLACK/PURPLE/RED/GRAY



COLOR SELECTION



-  BLACK
-  BLUE
-  PURPLE
-  EMERALD

Model V-02 1.8L
 TANK CAPACITY: 1.8L
 LIGHTING: LED LAMP
 COLOR: BLACK/BLUE/PEACHBLOW/EMERALD

PET CAGE





COLOR SELECTION

-  RED
-  PURPLE
-  BLUE

Model PT001
 DIMENSIONS: 195X130X120MM
 TANK CAPACITY: 3.5L



COLOR SELECTION

-  RED
-  PURPLE
-  BLUE

Model PT002
 DIMENSIONS: 233X150X165MM
 TANK CAPACITY: 4.5L

REPTILE CAGES



Model N11:
 20.25IN. HIGH X 14.5IN. WIDE



Model N20:
 16.25IN. HIGH X 14.5IN. WIDE

STAND



K400 500X370X690mm
K300 380X250X690mm

HAILEA CHILLER LINE PRODUCT



SUPER-SILENT CHILLER



Model HC-100A *NEW*

POWER: 1/20HP
VOLTAGE: 220-240V(110-120V)
FREQUENCY: 50HZ(60HZ)
WORKING CURRENT: 0.6A(1.3A)
WATER REFRIGERATED: 50-220L
REFRIGERANT: R134A
RATE OF FLOW: 200-1000L/H
WEIGHT: 9.2KG
SIZE: 338X218X325MM



Model HC-130A *NEW*

POWER: 1/15HP
VOLTAGE: 220-240V(110-120V)
FREQUENCY: 50HZ(60HZ)
WORKING CURRENT: 0.8A(1.6A)
WATER REFRIGERATED: 50-300L
REFRIGERANT: R134A
RATE OF FLOW: 200-1000L/H
WEIGHT: 9.5KG
SIZE: 338X218X325MM



Model HC-150A

POWER: 1/10HP
VOLTAGE: 220-240V(110-120V)
FREQUENCY: 50HZ(60HZ)
WORKING CURRENT: 1.1A(2.2A)
WATER REFRIGERATED: 50-400L
REFRIGERANT: R134A
RATE OF FLOW: 250-1200L/H
WEIGHT: 15KG
SIZE: 420X248X365MM



Model HC-250A

POWER: 1/6HP
VOLTAGE: 220-240V(110-120V)
FREQUENCY: 50HZ(60HZ)
WORKING CURRENT: 1.3A(2.8A)
WATER REFRIGERATED: 100-600L
REFRIGERANT: R134A
RATE OF FLOW: 600-2200L/H
WEIGHT: 18KG
SIZE: 448X330X440MM



Model HC-300A

POWER: 1/4HP
VOLTAGE: 220-240V(110-120V)
FREQUENCY: 50HZ(60HZ)
WORKING CURRENT: 1.8A(3A)
WATER REFRIGERATED: 100-800L
REFRIGERANT: R134A
RATE OF FLOW: 1000-2500L/H
WEIGHT: 18.6KG
SIZE: 448X330X440MM



Model HC-500A

POWER: 1/2HP
VOLTAGE: 220-240V(110-120V)
FREQUENCY: 50HZ(60HZ)
WORKING CURRENT: 2.4A(4.4A)
WATER REFRIGERATED: 200-1200L
REFRIGERANT: R134A
RATE OF FLOW: 1200-3000L/H
WEIGHT: 22KG
SIZE: 475X360X490MM



Model HC-1000A

POWER: 1HP
VOLTAGE: 220-240V
FREQUENCY: 50HZ
WORKING CURRENT: 3.2A
WATER REFRIGERATED: 300-2000L
REFRIGERANT: R134A
RATE OF FLOW: 1500-4000L/H
WEIGHT: 31.3KG
SIZE: 520X400X480MM



Model HC-1000B

POWER: 1HP
VOLTAGE: 220-240V(110-120V)
FREQUENCY: 50HZ(60HZ)
WORKING CURRENT: 4.2A(9.6A)
WATER REFRIGERATED: 300-2500L
REFRIGERANT: R22
RATE OF FLOW: 1500-4000L/H
WEIGHT: 31.3KG
SIZE: 520X400X480MM



Model HC-1000BH

POWER: 1HP(COOL&HEAT)
VOLTAGE: 220-240V(110-120V)
FREQUENCY: 50HZ(60HZ)
WORKING CURRENT: 4.2A(9.6A)
WATER REFRIGERATED: 300-2500L
REFRIGERANT: R22
RATE OF FLOW: 1500-4000L/H
WEIGHT: 31.8KG
SIZE: 520X400X480MM

COLOR SELECTION:



DARK GRAY

MILKY WHITE



HAILEA AIR LINE PRODUCT



AIR PUMP



Model ACO-5501

POWER: 2W
VOLTAGE: 110/220V
FREQUENCY: 50/60Hz
PRESSURE: >0.01Mpa
OUTPUT: 1.3L/min
NOISE: <40dB
WEIGHT: 0.15kg
SIZE: 125x57x52mm



Model ACO-5502

POWER: 3.5W
VOLTAGE: 110/220V
FREQUENCY: 50/60Hz
PRESSURE: >0.012Mpa
OUTPUT: 3L/min
NOISE: <40dB
WEIGHT: 0.44kg
SIZE: 123x69x60mm



Model ACO-5503

POWER: 4W
VOLTAGE: 110/220V
FREQUENCY: 50/60Hz
PRESSURE: >0.015Mpa
OUTPUT: 3.5L/min
NOISE: <40dB
WEIGHT: 0.45kg
SIZE: 147x75.5x65.5mm



Model ACO-5504

POWER: 5W
VOLTAGE: 110/220V
FREQUENCY: 50/60Hz
PRESSURE: >0.02Mpa
OUTPUT: 4.5L/min
NOISE: <40dB
WEIGHT: 0.68kg
SIZE: 168x87.5x74mm



Model ACO-5505

POWER: 6.5W
VOLTAGE: 110/220V
FREQUENCY: 50/60Hz
PRESSURE: >0.025Mpa
OUTPUT: 5.5L/min
NOISE: <45dB
WEIGHT: 0.82kg
SIZE: 181x96x76mm



Model ACO-9901

POWER: 2.2W
VOLTAGE: 110/220V
FREQUENCY: 50/60Hz
PRESSURE: >0.01Mpa
OUTPUT: 1.3L/min
WEIGHT: 0.24kg
SIZE: 104x61x51mm



Model ACO-9902

POWER: 2.5W
VOLTAGE: 110/220V
FREQUENCY: 50/60Hz
PRESSURE: >0.01Mpa
OUTPUT: 2.5L/min
WEIGHT: 0.37kg
SIZE: 129x70x58mm



Model ACO-9903

POWER: 3W
VOLTAGE: 110/220V
FREQUENCY: 50/60Hz
PRESSURE: >0.012Mpa
OUTPUT: 4.2L/min
WEIGHT: 0.49kg
SIZE: 138x88x52mm



Model ACO-9904

POWER: 3.5W
VOLTAGE: 110/220V
FREQUENCY: 50/60Hz
PRESSURE: >0.012Mpa
OUTPUT: 5.5L/min
WEIGHT: 0.62kg
SIZE: 149x98x59mm



Model ACO-9905

POWER: 6W
VOLTAGE: 110/220V
FREQUENCY: 50/60Hz
PRESSURE: >0.015Mpa
OUTPUT: 6.5L/min
WEIGHT: 0.8kg
SIZE: 158x94x68mm



Model ACO-2201

POWER: 1.8W
VOLTAGE: 110/220V
FREQUENCY: 50/60Hz
PRESSURE: >0.012Mpa
OUTPUT: 1.3L/min
NOISE: <40dB
WEIGHT: 0.23kg
SIZE: 88x60x53mm



Model ACO-2202

POWER: 2W
VOLTAGE: 110/220V
FREQUENCY: 50/60Hz
PRESSURE: >0.015Mpa
OUTPUT: 1.6L/min
NOISE: <40dB
WEIGHT: 0.27kg
SIZE: 110x68x63mm



Model ACO-2203

POWER: 2.5W
VOLTAGE: 110/220V
FREQUENCY: 50/60Hz
PRESSURE: >0.018Mpa
OUTPUT: 2.0L/min
NOISE: <40dB
WEIGHT: 0.36kg
SIZE: 140x78.5x75mm



Model ACO-2204

POWER: 4W
VOLTAGE: 110/220V
FREQUENCY: 50/60Hz
PRESSURE: >0.02Mpa
OUTPUT: 2.0x2L/min
NOISE: <40dB
WEIGHT: 0.64kg
SIZE: 156x95x75mm



Model ACO-2205

POWER: 5W
VOLTAGE: 110/220V
FREQUENCY: 50/60Hz
PRESSURE: >0.025Mpa
OUTPUT: 2.2x2L/min
NOISE: <40dB
WEIGHT: 0.73kg
SIZE: 166x100x77mm



Model ACO-2206

POWER: 8W
VOLTAGE: 110/220V
FREQUENCY: 50/60Hz
PRESSURE: >0.02Mpa
OUTPUT: 2.5x4L/min
NOISE: <40dB
WEIGHT: 1.25kg
SIZE: 189x120x100mm



Model ACO-2208

POWER: 25W
VOLTAGE: 110/220V
FREQUENCY: 50/60Hz
PRESSURE: >0.025Mpa
OUTPUT: 30L/min
NOISE: <45dB
WEIGHT: 1.25kg
SIZE: 221x156x125mm



Model ACO-9601

POWER: 2W
VOLTAGE: 110/220V
FREQUENCY: 50/60Hz
PRESSURE: >0.012Mpa
OUTPUT: 3.2L/min
NOISE: <40dB
WEIGHT: 0.4kg
SIZE: 136x78x68mm



Model ACO-9602

POWER: 5W
VOLTAGE: 110/220V
FREQUENCY: 50/60Hz
PRESSURE: >0.012Mpa
OUTPUT: 7.2L/min
NOISE: <40dB
WEIGHT: 0.53kg
SIZE: 162x100x87mm



Model ACO-9610

POWER: 10W
VOLTAGE: 110/220V
FREQUENCY: 50/60Hz
PRESSURE: >0.015Mpa
OUTPUT: 10L/min
NOISE: <45dB
WEIGHT: 1.5kg
SIZE: 187x145x95mm



Model ACO-9620

POWER: 12W
VOLTAGE: 110/220V
FREQUENCY: 50/60Hz
PRESSURE: >0.015Mpa
OUTPUT: 14L/min
NOISE: <45dB
WEIGHT: 2.1kg
SIZE: 224x163x126mm



Model ACO-9630

POWER: 15W
VOLTAGE: 110/220V
FREQUENCY: 50/60Hz
PRESSURE: >0.015Mpa
OUTPUT: 16L/min
NOISE: <45dB
WEIGHT: 2.7kg
SIZE: 248x176x137mm



Model UAS-12000

POWER: 8W
VOLTAGE: 110/220V
FREQUENCY: 50/60Hz
PRESSURE: >0.02Mpa
OUTPUT: 5L/min
DC WORKING TIME: 10h
WEIGHT: 2.25kg
SIZE: 186x170x60mm



Model UAS-15000

POWER: 5W
VOLTAGE: 110/220V
FREQUENCY: 50/60Hz
PRESSURE: >0.01Mpa
OUTPUT: 3L/min
DC WORKING TIME: 10h
WEIGHT: 2.2kg
SIZE: 262x118x70mm



Model V-10

POWER: 10W
VOLTAGE: 100-115/220-240V
FREQUENCY: 50/60Hz
PRESSURE: >0.02Mpa
OUTPUT: 10L/min
NOISE: <35dB
WEIGHT: 1.3kg
SIZE: 129x122x101mm



Model V-20

POWER: 15W
VOLTAGE: 100-115/220-240V
FREQUENCY: 50/60Hz
PRESSURE: >0.02Mpa
OUTPUT: 20L/min
NOISE: <40dB
WEIGHT: 2.5kg
SIZE: 230x185x180mm



Model V-30

POWER: 26W
VOLTAGE: 110-115/220-240V
FREQUENCY: 50/60Hz
PRESSURE: >0.025Mpa
OUTPUT: 30L/min
NOISE: <40dB
WEIGHT: 3.5kg
SIZE: 245x202x205mm



Model V-60

POWER: 60W
VOLTAGE: 110-115/220-240V
FREQUENCY: 50/60Hz
PRESSURE: >0.03Mpa
OUTPUT: 60L/min
NOISE: <40dB
WEIGHT: 5.6kg
SIZE: 270x242x210mm



Model ACO-9720

POWER: 25W
VOLTAGE: 110/220V
FREQUENCY: 50/60Hz
PRESSURE: >0.025Mpa
OUTPUT: 30L/min
NOISE: <40dB
WEIGHT: 4.0kg
SIZE: 208x150x178mm



Model ACO-9725

POWER: 40W
VOLTAGE: 110/220V
FREQUENCY: 50/60Hz
PRESSURE: >0.03Mpa
OUTPUT: 50L/min
NOISE: <40dB
WEIGHT: 5.5kg
SIZE: 218x156x182mm



Model ACO-9730

POWER: 50W
VOLTAGE: 110/220V
FREQUENCY: 50/60Hz
PRESSURE: >0.03Mpa
OUTPUT: 60L/min
NOISE: <40dB
WEIGHT: 6.4kg
SIZE: 241x173x199mm



Model HAP-60

POWER: 45W
VOLTAGE: 100-115/220-240V
FREQUENCY: 50/60Hz
COMMON PRESSURE: 0.01Mpa
MAX PRESSURE: >0.035Mpa
OUTPUT: 60L/min
NOISE: <36dB
WEIGHT: 6.0kg
SIZE: 203x165x153mm



Model HAP-80

POWER: 65W
VOLTAGE: 100-115/220-240V
FREQUENCY: 50/60Hz
COMMON PRESSURE: 0.012Mpa
MAX PRESSURE: >0.035Mpa
OUTPUT: 80L/min
NOISE: <38dB
WEIGHT: 7.0kg
SIZE: 210x185x171mm



Model HAP-100

POWER: 80W
VOLTAGE: 100-115/220-240V
FREQUENCY: 50/60Hz
COMMON PRESSURE: 0.015Mpa
MAX PRESSURE: >0.038Mpa
OUTPUT: 100L/min
NOISE: <38dB
WEIGHT: 8.5kg
SIZE: 238x196x177mm



Model HAP-120

POWER: 95W
VOLTAGE: 100-115/220-240V
FREQUENCY: 50/60Hz
COMMON PRESSURE: 0.018Mpa
MAX PRESSURE: >0.038Mpa
OUTPUT: 120L/min
NOISE: <40dB
WEIGHT: 9.5kg
SIZE: 265x215x198mm



Model ACO-9810

POWER: 25W
VOLTAGE: 110/220V
FREQUENCY: 50/60Hz
PRESSURE: >0.025Mpa
OUTPUT: 30L/min
NOISE: <40dB
WEIGHT: 4.0kg
SIZE: 208x160x166mm



Model ACO-9820

POWER: 50W
VOLTAGE: 110/220V
FREQUENCY: 50/60Hz
PRESSURE: >0.03Mpa
OUTPUT: 60L/min
NOISE: <40dB
WEIGHT: 5.6kg
SIZE: 243x189x201mm

OZONIZER



Model HLO-100

POWER: 10W
VOLTAGE: 200~240V
FREQUENCY: 50Hz
PRESSURE: >0.01Mpa
OUTPUT: 3.5L/min
OZONE CAPACITY: 10~100mg/h
WEIGHT: 0.96kg
SIZE: 200x155x71mm



Model HLO-300

POWER: 15W
VOLTAGE: 200~240V
FREQUENCY: 50Hz
PRESSURE: >0.01Mpa
OUTPUT: 3.5L/min
OZONE CAPACITY: 30~300mg/h
WEIGHT: 0.96kg
SIZE: 200x155x71mm



Model HLO-800

POWER: 7W
VOLTAGE: 110/220V
FREQUENCY: 60/50Hz
PRESSURE: >0.01Mpa
OUTPUT: 3.5L/min
OZONE CAPACITY: 100mg/h
WEIGHT: 0.9kg
SIZE: 186x137x63mm



Model HLO-810

POWER: 10W
VOLTAGE: 110/220V
FREQUENCY: 60/50Hz
PRESSURE: >0.01Mpa
OUTPUT: 3.5L/min
OZONE CAPACITY: 200mg/h
WEIGHT: 1.5kg
SIZE: 198x192x72mm



Model HLO-820A

POWER: 50W
VOLTAGE: 110/220V
FREQUENCY: 60/50Hz
PRESSURE: >0.02Mpa
OUTPUT: 15L/min
OZONE CAPACITY: 2000mg/h
WEIGHT: 6.5kg
SIZE: 318x275x182mm

AIR COMPRESSOR



Model ACO-108

POWER: 20W
VOLTAGE: 110/220V
FREQUENCY: 50/60Hz
PRESSURE: >0.015Mpa
OUTPUT: 30L/min
NOISE: <50dB
WEIGHT: 0.6kg
SIZE: 125x70x68mm



Model ACO-208

POWER: 25W
VOLTAGE: 110/220V
FREQUENCY: 50/60Hz
PRESSURE: >0.015Mpa
OUTPUT: 46L/min
NOISE: <55dB
WEIGHT: 0.9kg
SIZE: 142x80x78mm



Model ACO-308

POWER: 30W
VOLTAGE: 110/220V
FREQUENCY: 50/60Hz
PRESSURE: >0.025Mpa
OUTPUT: 55L/min
NOISE: <60dB
WEIGHT: 1.2kg
SIZE: 159x90x95mm



Model ACO-318

POWER: 35/45W
VOLTAGE: 110/220V
FREQUENCY: 50/60Hz
PRESSURE: >0.025Mpa
OUTPUT: 70L/min
NOISE: <60dB
WEIGHT: 1.65kg
SIZE: 182x95x116mm



Model ACO-328

POWER: 55W
VOLTAGE: 110/220V
FREQUENCY: 50/60Hz
PRESSURE: >0.035Mpa
OUTPUT: 82L/min
NOISE: <60dB
WEIGHT: 2.8kg
SIZE: 199x108x133mm



Model ACO-388D

POWER: 70W
VOLTAGE: 110/220V
FREQUENCY: 50/60Hz
PRESSURE: >0.035Mpa
OUTPUT: 90L/min
NOISE: <60dB
WEIGHT: 3.3kg
SIZE: 232x120x148mm



Model ACO-009

POWER: 120W
VOLTAGE: 110/220V
FREQUENCY: 50/60Hz
PRESSURE: >0.04Mpa
OUTPUT: 120L/min
NOISE: <60dB
WEIGHT: 4.5kg
SIZE: 278x147x170mm



Model ACO-009D

POWER: 135W
VOLTAGE: 110/220V
FREQUENCY: 50/60Hz
PRESSURE: >0.04Mpa
OUTPUT: 125L/min
NOISE: <69dB
WEIGHT: 4.7kg
SIZE: 280x147x170mm



Model ACO-009E

POWER: 160W
VOLTAGE: 110/220V
FREQUENCY: 50/60Hz
PRESSURE: >0.04Mpa
OUTPUT: 145L/min
NOISE: <60dB
WEIGHT: 5.1kg
SIZE: 283x147x173mm



Model ACO-300A

POWER: 300W
VOLTAGE: 110/220V
FREQUENCY: 50/60Hz
PRESSURE: >0.04Mpa
OUTPUT: 250L/min
NOISE: <60dB
WEIGHT: 6.4kg
SIZE: 307x156x189mm



Model ACO-380

POWER: 380W
VOLTAGE: 110/220V
FREQUENCY: 50/60Hz
PRESSURE: >0.04Mpa
OUTPUT: 280L/min
NOISE: <60dB
WEIGHT: 6.5kg
SIZE: 310x155x189mm



Model ACO-450

POWER: 450W
VOLTAGE: 110/220V
FREQUENCY: 50/60Hz
PRESSURE: >0.045Mpa
OUTPUT: 280L/min
NOISE: <60dB
WEIGHT: 8.6kg
SIZE: 335x171x202mm



Model ACO-500

POWER: 500W
VOLTAGE: 110/220V
FREQUENCY: 50/60Hz
PRESSURE: >0.045Mpa
OUTPUT: 280L/min
NOISE: <65dB
WEIGHT: 8.6kg
SIZE: 337x171x202mm

VORTEX BLOWER



Model VB-125G

POWER: 125W
VOLTAGE: 220V
FREQUENCY: 50Hz
PRESSURE: >0.006Mpa
OUTPUT: 250L/min
WEIGHT: 6.2kg
SIZE: 235x179x186mm



Model VB-185G

POWER: 185W
VOLTAGE: 220V
FREQUENCY: 50Hz
PRESSURE: >0.007Mpa
OUTPUT: 300L/min
WEIGHT: 6.8kg
SIZE: 233x199x207mm



Model VB-290G

POWER: 290W
VOLTAGE: 220V
FREQUENCY: 50Hz
PRESSURE: >0.009Mpa
OUTPUT: 350L/min
WEIGHT: 7.4kg
SIZE: 230x199x215mm



Model VB-390G

POWER: 390W
VOLTAGE: 220V
FREQUENCY: 50Hz
PRESSURE: >0.01Mpa
OUTPUT: 500L/min
WEIGHT: 8.7kg
SIZE: 295x223x230mm



Model VB-600G

POWER: 600W
VOLTAGE: 220V
FREQUENCY: 50Hz
PRESSURE: >0.012Mpa
OUTPUT: 640L/min
WEIGHT: 9.8kg
SIZE: 256x246x256mm



Model VB-800G

POWER: 800W
VOLTAGE: 220V
FREQUENCY: 50Hz
PRESSURE: >0.015Mpa
OUTPUT: 1000L/min
WEIGHT: 15.4kg
SIZE: 295x295x305mm



Model VB-1200G

POWER: 1200W
VOLTAGE: 220V
FREQUENCY: 50Hz
PRESSURE: >0.019Mpa
OUTPUT: 1350L/min
WEIGHT: 19.3kg
SIZE: 315x310x325mm



Model VB-2200GP

POWER: 2200W
VOLTAGE: 380V
FREQUENCY: 50Hz
PRESSURE: >0.22Mpa
OUTPUT: 2100L/min
WEIGHT: 22.5kg
SIZE: 330x315x450mm

HAILEA WATER LINE PRODUCT



WATER PUMP



Model HX-800

POWER: 3W
VOLTAGE: 110-120/220-240V
FREQUENCY: 50/60Hz
FLOW: 280L/h
MAX. JET: 0.8M
OUTLET DIAMETER: \varnothing 9mm
WEIGHT: 0.23kg
SIZE: 66x65x80mm



Model HX-1000

POWER: 3W
VOLTAGE: 110-120/220-240V
FREQUENCY: 50/60Hz
FLOW: 200L/h
MAX. JET: 0.85M
OUTLET DIAMETER: \varnothing 10mm
WEIGHT: 0.20kg
SIZE: 55x65x80mm



Model HX-1500

POWER: 5W
VOLTAGE: 110-120/220-240V
FREQUENCY: 50/60Hz
FLOW: 400L/h
MAX. JET: 0.7M
OUTLET DIAMETER: \varnothing 12mm
WEIGHT: 0.30kg
SIZE: 63x73x85mm



Model HX-2000

POWER: 10W
VOLTAGE: 110-120/220-240V
FREQUENCY: 50/60Hz
FLOW: 650L/h
MAX. JET: 1.0M
OUTLET DIAMETER: \varnothing 14.5mm
WEIGHT: 0.50kg
SIZE: 90x73x110mm



Model HX-2500

POWER: 22W
VOLTAGE: 110-120/220-240V
FREQUENCY: 50/60Hz
FLOW: 650L/h
MAX. JET: 1.2M
OUTLET DIAMETER: \varnothing 14.5mm
WEIGHT: 0.6kg
SIZE: 112x95x105mm



Model HX-4500

POWER: 70W
VOLTAGE: 110-120/220-240V
FREQUENCY: 50/60Hz
FLOW: 2500L/h
MAX. JET: 3.0M
OUTLET DIAMETER: \varnothing 20mm
WEIGHT: 1.6kg
SIZE: 150x135x120mm



Model HX-4500A

POWER: 70W
VOLTAGE: 110-120/220-240V
FREQUENCY: 50/60Hz
FLOW: 2500L/h
MAX. JET: 3.0M
OUTLET DIAMETER: \varnothing 20mm
WEIGHT: 1.6kg
SIZE: 150x135x120mm



Model HL-F25

POWER: 50W
VOLTAGE: 110-120/220-240V
FREQUENCY: 50/60Hz
FLOW: 2500L/h
MAX. JET: 2.4M
OUTLET DIAMETER: 21.5mm
WEIGHT: 1.2kg
SIZE: 160x140x125mm



Model HX-5000

POWER: 90W
VOLTAGE: 110-120/220-240V
FREQUENCY: 50/60Hz
FLOW: 3000L/h
MAX. JET: 2.5M
OUTLET DIAMETER: \varnothing 20mm
WEIGHT: 0.92kg
SIZE: 148x125x130mm



Model HX-6830

POWER: 100W
VOLT: 110-120/220-240V
FREQUENCY: 50/60Hz
FLOW: 3000L/h
MAX. JET: 3.2M
DIAMETER: \varnothing 23.5mm
WEIGHT: 1.0kg
SIZE: 207x98x162mm



Model HX-6840

POWER: 150W
VOLT: 110-120/220-240V
FREQUENCY: 50/60Hz
FLOW: 5000L/h
MAX. JET: 4.0M
DIAMETER: \varnothing 26.5mm
WEIGHT: 1.9kg
SIZE: 227x115x177mm



Model HX-6850

POWER: 200W
VOLT: 110-120/220-240V
FREQUENCY: 50/60Hz
FLOW: 7000L/h
MAX. JET: 5.0M
DIAMETER: \varnothing 32mm
WEIGHT: 3.0kg
SIZE: 269x126x206mm



Model HX-6510

POWER: 10W
VOLTAGE: 110-120/220-240V
FREQUENCY: 50/60Hz
FLOW: 480L/h
MAX. JET: 1.2M
OUTLET DIAMETER: \varnothing 12mm
WEIGHT: 0.8kg
SIZE: 112x85x129mm



Model HX-6520

POWER: 35W
VOLTAGE: 110-120/220-240V
FREQUENCY: 50/60Hz
FLOW: 1000L/h
MAX. JET: 1.6M
OUTLET DIAMETER: \varnothing 14.5mm
WEIGHT: 1.0kg
SIZE: 132x98x150mm



Model HX-6530

POWER: 50W
VOLTAGE: 110-120/220-240V
FREQUENCY: 50/60Hz
FLOW: 1750L/h
MAX. JET: 2.3M
OUTLET DIAMETER: \varnothing 17.5mm
WEIGHT: 1.7kg
SIZE: 154x120x170mm



Model HX-6540

POWER: 100W
VOLTAGE: 110-120/220-240V
FREQUENCY: 50/60Hz
FLOW: 2680L/h
MAX. JET: 3.1M
OUTLET DIAMETER: \varnothing 20mm
WEIGHT: 3.3kg
SIZE: 185x150x180mm



Model HX-6550

POWER: 200W
VOLTAGE: 110-120/220-240V
FREQUENCY: 50/60Hz
FLOW: 5580L/h
MAX. JET: 4.0M
OUTLET DIAMETER: \varnothing 24.5mm
WEIGHT: 4.6kg
SIZE: 202x156x225mm



Model HX-8810

POWER: 20W
VOLT: 110-120/220-240V
FREQUENCY: 50/60Hz
FLOW: 1000L/h
MAX. JET: 1.95M
DIAMETER: \varnothing 14/19mm
WEIGHT: 0.6kg
SIZE: 136x75x120mm



Model HX-8830

POWER: 60W
VOLT: 110-120/220-240V
FREQUENCY: 50/60Hz
FLOW: 3100L/h
MAX. JET: 2.4M
DIAMETER: \varnothing 19.5mm
WEIGHT: 1.6kg
SIZE: 226x115x175mm



Model HX-8840

POWER: 100W
VOLT: 110-120/220-240V
FREQUENCY: 50/60Hz
FLOW: 4100L/h
MAX. JET: 2.8M
DIAMETER: \varnothing 22.5mm
WEIGHT: 2.5kg
SIZE: 232x130x200mm



Model HX-8860

POWER: 150W
VOLT: 110-120/220-240V
FREQUENCY: 50/60Hz
FLOW: 6500L/h
MAX. JET: 4.2M
DIAMETER: \varnothing 27.5mm
WEIGHT: 2.9kg
SIZE: 152x285x168mm



Model HX-8890

POWER: 240W
VOLT: 110-120/220-240V
FREQUENCY: 50/60Hz
FLOW: 9000L/h
MAX. JET: 5.8M
DIAMETER: \varnothing 11 $\frac{3}{4}$ "
WEIGHT: 3.4kg
SIZE: 305x162x183mm



Model HX-8200

POWER: 100W
VOLTAGE: 110-120/220-240V
FREQUENCY: 50/60Hz
MAX. JET: 3.2m
FLOW: 2500L/h
OUTLET DIAMETER: \varnothing 24.5/20mm
WEIGHT: 3.3kg
SIZE: 145x145x230mm



Model HX-8400

POWER: 150W
VOLTAGE: 110-120/220-240V
FREQUENCY: 50/60Hz
MAX. JET: 4.2m
FLOW: 4500L/h
OUTLET DIAMETER: \varnothing 27/21.5mm
WEIGHT: 4.8kg
SIZE: 166x178x255mm



Model HX-8670

POWER: 240W
VOLTAGE: 110-120/220-240V
FREQUENCY: 50Hz
MAX. JET: 6.1m
FLOW: 7000L/h
OUTLET DIAMETER: \varnothing 16/20mm
WEIGHT: 3.8kg
SIZE: 178x178x245mm



Model HX-8670A

POWER: 240W
VOLTAGE: 110-120/220-240V
FREQUENCY: 50Hz
MAX. JET: 6.1m
FLOW: 7000L/h
OUTLET DIAMETER: \varnothing 16/20mm
WEIGHT: 3.8kg
SIZE: 178x178x245mm



Model HX-8300

POWER: 100W
VOLTAGE: 110-120/220-240V
FREQUENCY: 50/60Hz
MAX. JET: 3.2m
FLOW: 2500L/h
OUTLET DIAMETER: \varnothing 24.5/20mm
WEIGHT: 3.3kg
SIZE: 160x160x212mm



Model HX-8500

POWER: 150W
VOLTAGE: 110-120/220-240V
FREQUENCY: 50/60Hz
MAX. JET: 4.2m
FLOW: 4500L/h
OUTLET DIAMETER: \varnothing 27/21.7mm
WEIGHT: 5.0kg
SIZE: 178x178x245mm



Model HX-8500A

POWER: 150W
VOLTAGE: 110-120/220-240V
FREQUENCY: 50Hz
MAX. JET: 4.2m
FLOW: 4500L/h
OUTLET DIAMETER: \varnothing 27/21.7mm
WEIGHT: 5.0kg
SIZE: 178x178x245mm

POND PUMPS

HAILEA
SINCE 1989

POND PUMPS

HX-88 SERIES



Model HX-8810F
POWER: 20W
VOLT.: 110-120/220-240V
FREQUENCY: 50/60Hz
FLOW: 1000L/h
MAX JET: 1.95M
DIAMETER: \varnothing 14/19mm
WEIGHT: 0.6kg
SIZE: 136x75x120mm



Model HX-8830F
POWER: 60W
VOLT.: 110-120/220-240V
FREQUENCY: 50/60Hz
FLOW: 3100L/h
MAX JET: 2.4M
DIAMETER: \varnothing 19.5mm
WEIGHT: 1.6kg
SIZE: 226x115x175mm



Model HX-8840F
POWER: 100W
VOLT.: 110-120/220-240V
FREQUENCY: 50/60Hz
FLOW: 4100L/h
MAX JET: 2.8M
DIAMETER: \varnothing 22.5mm
WEIGHT: 2.5kg
SIZE: 232x130x200mm



Model HX-8860F
POWER: 150W
VOLT.: 110-120/220-240V
FREQUENCY: 50/60Hz
FLOW: 6500L/h
MAX JET: 4.2M
DIAMETER: \varnothing 27.5mm
WEIGHT: 2.9kg
SIZE: 152x285x168mm



Model HX-8890F
POWER: 240W
VOLT.: 110-120/220-240V
FREQUENCY: 50/60Hz
FLOW: 9000L/h
MAX JET: 5.8M
DIAMETER: \varnothing 1" $\frac{3}{4}$ "
WEIGHT: 3.4kg
SIZE: 305x162x183mm

H SERIES



MODEL	H5000	H6000	H8000	H9000	H10000
POWER	55W	60W	80W	100W	115W
VOLT.	110~120 / 220~240V				
FREQ.	50/60Hz				
FLOW	5200L/H	6100L/H	8000L/H	9000L/H	10000L/H
MAX JET	1.6m	2.0m	2.5m	3.2m	4m
DIAMETER	\varnothing 1 $\frac{1}{2}$ "				
SIZE	359x135x162mm				

MODEL	H12000	H15000	H18000	H20000	H22000
POWER	162W	265W	320W	400W	450W
VOLT.	110~120 / 220~240V				
FREQ.	50/60Hz				
FLOW	12100L/H	15000L/H	17200L/H	20000L/H	22000L/H
MAX JET	4.8m	5.4m	6.5m	6.7m	7.5m
DIAMETER	\varnothing 1 $\frac{1}{2}$ "				
SIZE	402x165x189mm				

HAILEA FILTER LINE PRODUCT

INTERNAL FILTER



Model HL-BT100
 8W
 VOLTAGE: 110-120/220-240V
 FREQUENCY: 50/60Hz
 FLOW: 150L/h
 MAX JET: 0.5M
 SIZE: 43x37x31mm



Model HL-BT200
 9W
 VOLTAGE: 110-120/220-240V
 FREQUENCY: 50/60Hz
 FLOW: 200L/h
 MAX JET: 0.5M
 AQUARIUM SIZE: 60L
 WEIGHT: 0.23kg
 SIZE: 33.5x42.5x135mm



Model HL-BT400
 11W
 VOLTAGE: 110-120/220-240V
 FREQUENCY: 50/60Hz
 FLOW: 300L/h
 MAX JET: 0.9M
 AQUARIUM SIZE: 90-110L
 WEIGHT: 0.35kg
 SIZE: 43x57x188mm



Model HL-BT700
 10W
 VOLTAGE: 110-120/220-240V
 FREQUENCY: 50/60Hz
 FLOW: 650L/h
 MAX JET: 1.25M
 AQUARIUM SIZE: 70-250L
 WEIGHT: 0.64kg
 SIZE: 74x77x212mm



Model HL-BT1000
 20W
 VOLTAGE: 110-120/220-240V
 FREQUENCY: 50/60Hz
 FLOW: 1000L/h
 MAX JET: 1.95M
 AQUARIUM SIZE: 90-360L
 WEIGHT: 0.8kg
 SIZE: 79x90x230mm



REFILL PACK
 Model BTP-200/400/700/1000

EXTERNAL FILTER



Model HF-150
 POWER: 13W
 VOLTAGE: 100-120/220-240V
 FREQUENCY: 50/60Hz
 PUMPFLOW: 800L/h
 FILTER VOLUME: 4.5L
 WATER JET: <2m
 AQUARIUM SIZE: 150-300L
 SIZE: 250x220x352mm



Model HF-300
 POWER: 16W
 VOLTAGE: 100-120/220-240V
 FREQUENCY: 50/60Hz
 PUMPFLOW: 1200L/h
 FILTER VOLUME: 6.0L
 WATER JET: <2m
 AQUARIUM SIZE: 250-500L
 SIZE: 250x220x415mm



Model HF-150A
 POWER: 13W
 VOLTAGE: AC 12/24V
 FREQUENCY: 50/60Hz
 PUMPFLOW: 800L/h
 FILTER VOLUME: 4.5L
 WATER JET: <2m
 AQUARIUM SIZE: 150-300L
 SIZE: 250x220x352mm



Model HF-300A
 POWER: 16W
 VOLTAGE: AC 12/24V
 FREQUENCY: 50/60Hz
 PUMPFLOW: 1200L/h
 FILTER VOLUME: 6.0L
 WATER JET: <2m
 AQUARIUM SIZE: 250-500L
 SIZE: 250x220x415mm



Model H-12
 POWER: 20W
 VOLTAGE: AC 110-120/220-240V
 FREQUENCY: 50/60Hz
 FLOW: 1200L/h
 MAX JET: 1.5m
 RECOMMENDED AQUARIUM: 100-285L
 WEIGHT: 1.0kg
 SIZE: DIAMETER 169xHIGH 1345mm



Model H-12A
 POWER: 20W
 VOLTAGE: AC 12/24V
 FREQUENCY: 50/60Hz
 FLOW: 1200L/h
 MAX JET: 1.5m
 RECOMMENDED AQUARIUM: 100-285L
 WEIGHT: 1.0kg
 SIZE: DIAMETER 169xHIGH 1345mm

POWER FILTER



Model SL-106
 VOLTAGE: AC 220V
 FREQUENCY: 50/60Hz
 POWER: 3.5W
 FLOW: 250L/h
 SIZE: 110x95x124mm



Model SL-206
 VOLTAGE: AC 220V
 FREQUENCY: 50/60Hz
 POWER: 4.5W
 FLOW: 500L/h
 SIZE: 166x106x178mm



Model SL-306
 VOLTAGE: AC 110-120/220-240V
 FREQUENCY: 50/60Hz
 POWER: 5W
 FLOW: 500L/h
 SIZE: 216x216x139mm

AIR FILTER SET

Model FT-201 WITH AIR PUMP



FILTER: FT-201



PLASTIC PLANT: M-013



AIR PUMP: ACO-9901



PLASTIC TUBE: 1.50M



AIR STONE: A003



CHECK VALVE